

# Gateway PSC05

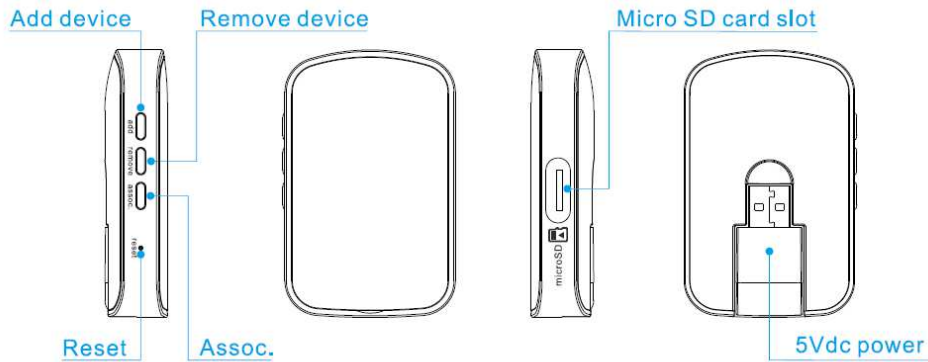

## Introduction:

Transform any home, shop or the office into a smart building with the Philio PSC05-X Z-Wave/Zigbee Smart USB Gateway. This USB Gateway is the slimmest Z-Wave/Zigbee Gateway of the world and can be easily adapted to your current Z-Wave/Zigbee/Wi-Fi home automation network. Power on the USB gateway by plugging to your USB outlet (5Vdc, 1A) and create the perfect ambience for any environment. Providing ultimate flexibility, the Philio Z-Wave/Zigbee Smart USB Gateway allows you to operate the home automation and to easily communicate with any Philio Z-Wave/Zigbee devices (sensors, switches, remote controls, siren, etc.).

## Specification

Rated	DC5V 300mA (from adapter DC5V 1A or USB) Backup battery 3.7Vdc 220mAh (Li battery)
RF distance (Z-wave)	Min. 40M indoor, 100M outdoor line of sight,
RF Frequency (Z-wave)	868.40 MHz, 869.85 MHz (EU) 908.40 MHz, 916.00 MHz (US) 920.9MHz, 921.7MHz, 923.1MHz (TW/KR/Thai/SG)
RF Maximum Power	+5dBm
RF Frequency (Wi-Fi)	Wi-Fi IEEE 802.11 b/g/n
RF Maximum Power	+20dBm
Location	indoor use only
Operation temperature	0 to 40 °C
Humidity	85%RH max
FCC ID	RHHPSC05

Specifications are subject to change and improvement without notice.

## CAUTION

- replacement of a battery with an incorrect type that can defeat a safeguard (for example, in the case of some lithium battery types);
- disposal of a battery into fire or a hot oven, or mechanically crushing or cutting of a battery, that can result in an explosion;
- leaving a battery in an extremely high temperature surrounding environment that can result in an explosion or the leakage of flammable liquid or gas;
- a battery subjected to extremely low air pressure that may result in an explosion or the leakage of flammable liquid or gas

The marking information is located at the bottom of the apparatus.

## Troubleshooting

Symptom	Cause of Failure	Recommendation
The device can not join to Z-Wave™ network	The device may in a Z-Wave™ network.	Exclude the device then include again.

For Instruction to [http:// www.philio-tech.com](http://www.philio-tech.com)



## Getting Started

### 1. Install APP "Home Mate2"

Please download " Home Mate 2 " App from Google/App stores



Home Mate2



IOS



Android

### 2. Power up the gateway

Power up the gateway to any 5V DC USB port and wait until red LED on. And connect by using SSID in Wi-Fi connection of your mobile phone.

Default SSID : PSC05 : XX:XX:XX:XX:XX:XX  
Default Password : 12345678

## Getting Started

### 3. Find Gateway

Launch the " Home Mate 2" App, press the search button connecting to the PSC05 WiFi gateway and retrieve the gateway's UID. Or you can scan the QR code directly to retrieve the gateway UID and then key in the default password " 888888".

UID

Name

ID

Password

**Login**

[Scan local Gateway.](#)

[Scan QR code from Gateway rear side.](#)

[888888](#)

## Getting Started

### 4. Gateway Connect To Internet

To connect the PSC05 gateway to your local WiFi router, please go to setting page  
Setting page → Gateway Information → Wi-Fi network → STA mode → select the SSID of the preferred router

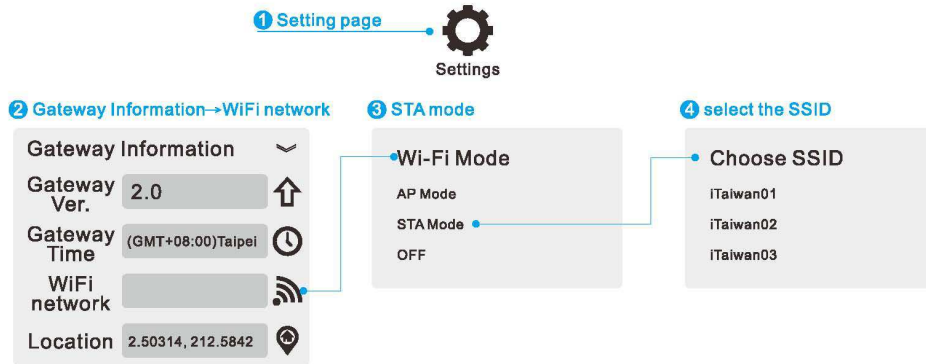

**Remark:**  
If the WiFi gateway couldn't be found in your smartphone WiFi list, please use paper clip to press the "reset" and hold the button until red LED off (around 20 seconds). The gateway will reboot around 20 sec. later and red LED light keep steady on.

## Getting Started

### 5. APP Connect to Gateway

Let your mobile phone connect to internet and the select gateway that you want to connect by long press icon of home mate2 as below.



## Getting Started

### 6. Reset function

If Gateway setting done and you would like carry Gateway to new place, press reset button as below, Press 10s then release, Gateway will reset. Follow Getting Started step 1 again you will setting done in new place.

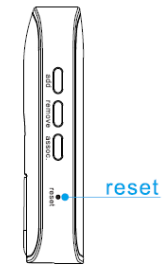

## Setup Devices

1. To add sensor devices or WiFi IP camera by pressing the "+" in "Devices" page



2. Select "Include Device" → press "START INCLUSION" (the gateway LED will be flashing as confirmation to proceed in inclusion mode)



3. To pull out the black Insulation Mylar from battery cover, the sensor will send signal to gateway automatically and complete the inclusion.

## Setup Devices

4. If the sensor being included in other gateway before, please be sure to "Exclusion" the sensor firstly before you "INCLUSION" it to the new gateway. Here is the example to add 4 in 1 sensor to another gateway for reference. For other sensors, please refer to below "Remark".

### Method A:

- 1 In App Device page → Press "+" → Include Device → Press "Exclusion"

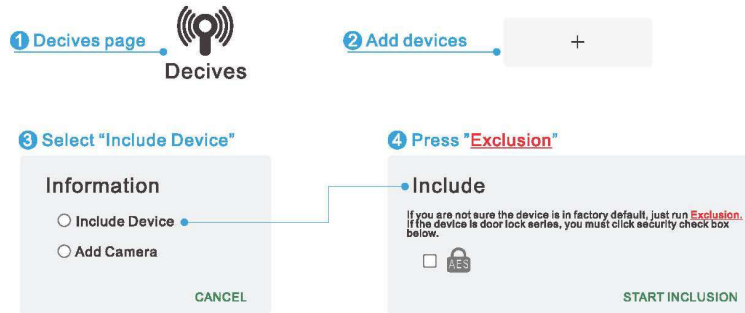

## Setup Devices

### Method B:

- 1 Press the "remove" button on the gateway. Once the gateway red LED blinking → Press tamper key three times within 1.5 seconds → App will show "device excluded" → Then press the "add" button on the gateway within 20 seconds, the gateway red LED will be blinking as confirmation to start Exclusion process. (Once the sensor be added, the gateway red LED will be on.)

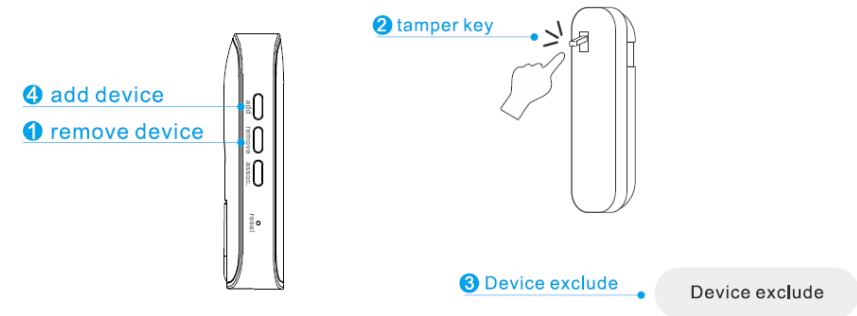

## Setup Devices

- 2 Once the gateway red LED blinking → Press tamper key three times within 1.5 seconds → App will show "Device excluded" on App once completed exclusion → And then press "START INCLUSION" within 20 seconds



## Setup Devices

5. Once completed inclusion: You could appoint sensors in different rooms by adding "+" new rooms.



This block right side as name and status, click right side to control device, click left side to setup advance setting.

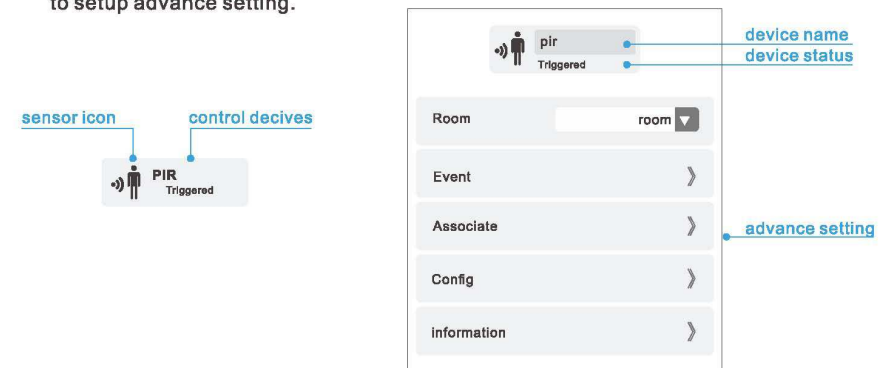

## Scenes

Press the "+" button to add the new Scenes, you may change the scenes icon/name as you wish and select devices you would like to add.



## Settings

In setting page you could retrieve App and the gateway detailed information by clicking into each option.

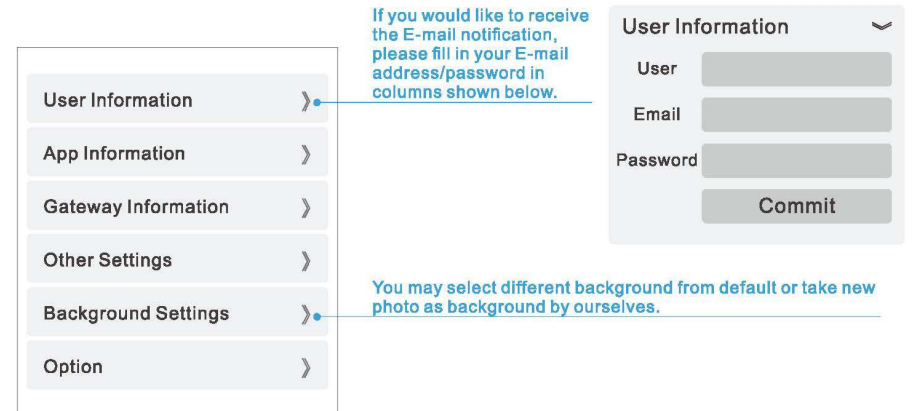

## Macros

Press the "+" button to add the new Macros group, you may change the macros icon/name as you wish and set up the scenario with If and Then or Option criteria.

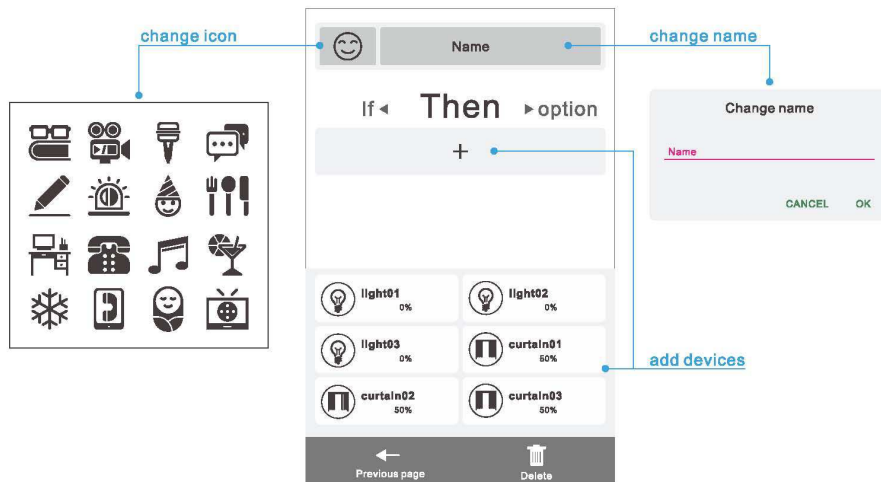

## Advanced Function/Setting

### 1. Associate function:

The gateway is as console to communication/control sensor devices included. However, the individual sensors could be associated to each other and communicate directly without waiting further commands from Gateway to speed up the response time. For example, you may the dimmer switch could be controlled by gateway side and also smart button.

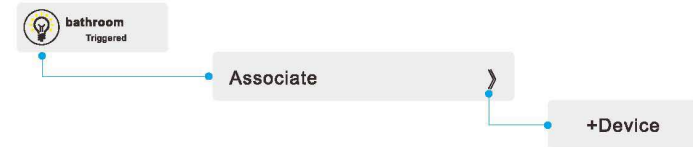



## Advanced Function/Setting

### 2. Re-configuration Function:

You may change the default setting according to your demand. For example, the sensitivity default setting is 80. You may lower the sensitivity to 50 by key in below new figures.

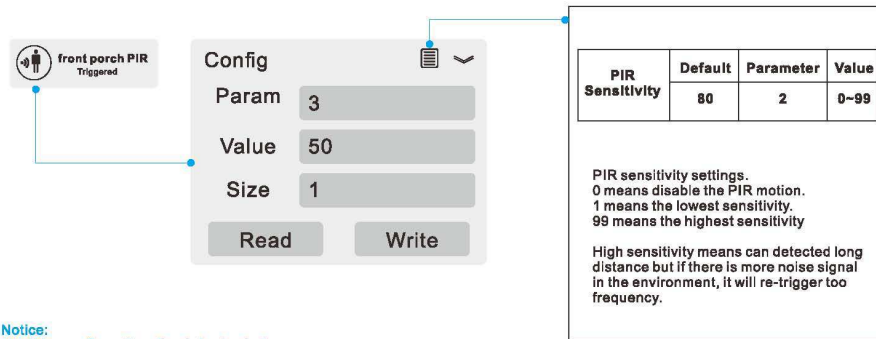

PIR Sensitivity	Default	Parameter	Value
	80	2	0-99

PIR sensitivity settings.  
0 means disable the PIR motion.  
1 means the lowest sensitivity.  
99 means the highest sensitivity

High sensitivity means can detected long distance but if there is more noise signal in the environment, it will re-trigger too frequency.

**Notice:**

- ※ All of the configuration, the data size is 1.
- ※ The configuration mark with star(\*), means after the remove the setting still keep, don't reset to factory default. Unless the user execute the "RESET" procedure.
- ※ The reserve bit or not supported bit is allowed any value, but no effect.

## Over The Air (OTA) Firmware Update

The device support the Z-Wave firmware update via OTA.

Let the controller into the firmware update mode, and then wake up the device to start the update.

After finish the firmware download, the LED will start flash in every 0.5 second. Wait the LED stop flash, the firmware update is succeeded.

**Caution:** Do not running the OTA when the battery is running low.

## Disposal



This marking indicates that this product should not be disposed with other household wastes throughout the EU. To prevent possible harm to the environment or human health from uncontrolled waste disposal, recycle it responsibly to promote the sustainable reuse of material resources. To return your used device, please use the return and collection systems or contact the retailer where the product was purchased. They can take this product for environmental safe recycling.

Philio Technology Corporation

8F., No.653-2, Zhongzheng Rd., Xinzhuang Dist., New Taipei City 24257, Taiwan(R.O.C)

[www.philio-tech.com](http://www.philio-tech.com)

## FCC Interference Statement

This equipment has been tested and found to comply with the limits for a Class B digital device, pursuant to Part 15 of the FCC Rules. These limits are designed to provide reasonable protection against harmful interference in a residential installation. This equipment generates, uses and can radiate radio frequency energy and, if not installed and used in accordance with the instructions, may cause harmful interference to radio communications. However, there is no guarantee that interference will not occur in a particular installation. If this equipment does cause harmful interference to radio or television reception, which can be determined by turning the equipment off and on, the user is encouraged to try to correct the interference by one of the following measures:

- Reorient or relocate the receiving antenna.
- Increase the separation between the equipment and receiver.

- Connect the equipment into an outlet on a circuit different from that to which the receiver is connected.
- Consult the dealer or an experienced radio/TV technician for help.

This device complies with Part 15 of the FCC Rules. Operation is subject to the following two conditions:

- (1) This device may not cause harmful interference, and
- (2) This device must accept any interference received, including interference that may cause undesired operation.

FCC Caution: Any changes or modifications not expressly approved by the party responsible for compliance could void the user's authority to operate this equipment.

This transmitter must not be co-located or operating in conjunction with any other antenna or transmitter.

## Warning

Do not dispose of electrical appliances as unsorted municipal waste, use separate collection facilities. Contact your local government for information regarding the collection systems available. If electrical appliances are disposed of in landfills or dumps, hazardous substances can leak into the groundwater and get into the food chain, damaging your health and well-being.

When replacing old appliances with new ones, the retailer is legally obligated to take back your old appliance for disposal at least for free of charge.

### 警語:

「取得審驗證明之低功率射頻器材，非經核准，公司、商號或使用者均不得擅自變更頻率、加大功率或變更原設計之特性及功能。

低功率射頻器材之使用不得影響飛航安全及干擾合法通信；經發現有干擾現象時，應立即停用，並改善至無干擾時方得繼續使用。

前述合法通信，指依電信管理法規定作業之無線電通信。低功率射頻器材須忍受合法通信或工業、科學及醫療用電波輻射性電機設備之干擾。」